

Condover Quarry

Site Biodiversity Action Plan



Site Information - Condover

Site Name and Location	Condover Quarry, Shropshire (SJ 492070)
Hanson Company	Hanson Aggregates - North
BAP(s) that will be targeted	UK BAP Shropshire BAP
BAP Habitat(s) to be developed	Broadleaved and Mixed Woodland Open mosaic, wetland, hedgerows
BAP species to be encouraged	<i>Mammals</i> : Great Crested Newt, badger, farmland birds
Designated Natural Area	The Shropshire Plain
Background and site description	Condover will be restored to semi-natural broadleaved woodland to augment existing neighbouring ancient semi-natural woodland in the area with open water, marsh areas, hedgerows, and permanent pasture.
National Designations (SSSI, SAC, SPAs, RAMSARs and NPs) within 500m	RAMSAR site: Midland Meres and Mosses SSSI - Bowmere, Shomere and Betton Pools SSSI: Ref: 1002298
Resource Requirements	Pre-stripping ecological surveys and protected species monitoring reports, which are planning and legislative requirements. Protection of existing habitat features & GCN population. Creation of woodland, ponds, lakes and other wetland features are all part of the approved restoration scheme. Works funded by restoration budget.
Contribution to biodiversity & benefits	Woodland and wetland creation is both a local and national BAP habitat target. Restoration of the site will fit with the existing designated local wildlife site and increase the biodiversity value of the area as a whole.
Partners and Local initiatives	Shropshire Wildlife Trust.
Other documents supporting the site BAP	Site Restoration Plan Condover Quarry Management Plan Protected species reports (confidential).

Condover Restoration Plan

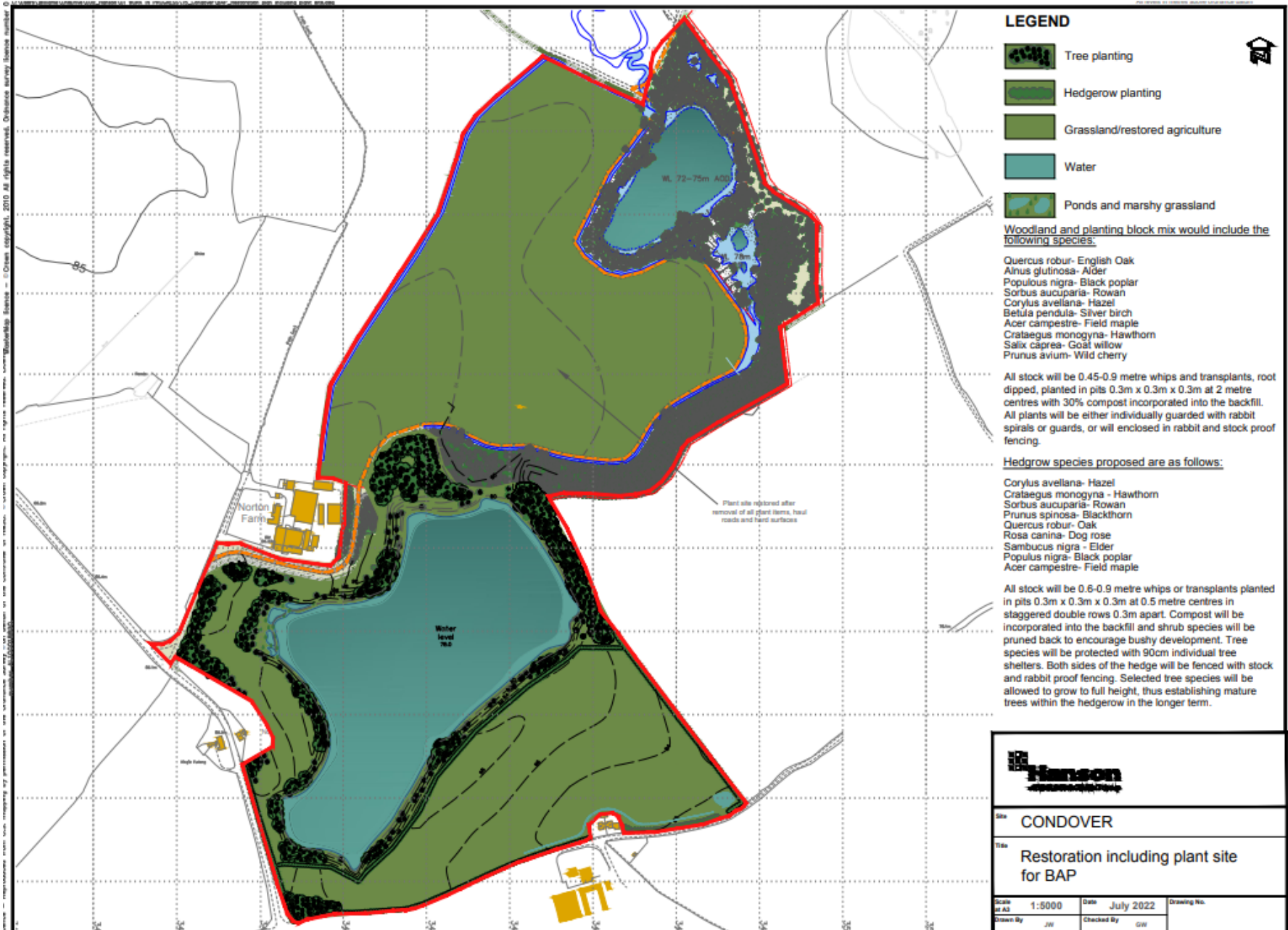

LEGEND

-  Tree planting
-  Hedgerow planting
-  Grassland/restored agriculture
-  Water
-  Ponds and marshy grassland

Woodland and planting block mix would include the following species:

- Quercus robur- English Oak
- Alnus glutinosa- Alder
- Populus nigra- Black poplar
- Sorbus aucuparia- Rowan
- Corylus avellana- Hazel
- Betula pendula- Silver birch
- Acer campestre- Field maple
- Crataegus monogyna- Hawthorn
- Salix caprea- Goat willow
- Prunus avium- Wild cherry

All stock will be 0.45-0.9 metre whips and transplants, root dipped, planted in pits 0.3m x 0.3m x 0.3m at 2 metre centres with 30% compost incorporated into the backfill. All plants will be either individually guarded with rabbit spirals or guards, or will be enclosed in rabbit and stock proof fencing.

Hedgerow species proposed are as follows:

- Corylus avellana- Hazel
- Crataegus monogyna - Hawthorn
- Sorbus aucuparia- Rowan
- Prunus spinosa- Blackthorn
- Quercus robur- Oak
- Rosa canina- Dog rose
- Sambucus nigra - Elder
- Populus nigra- Black poplar
- Acer campestre- Field maple

All stock will be 0.6-0.9 metre whips or transplants planted in pits 0.3m x 0.3m x 0.3m at 0.5 metre centres in staggered double rows 0.3m apart. Compost will be incorporated into the backfill and shrub species will be pruned back to encourage bushy development. Tree species will be protected with 90cm individual tree shelters. Both sides of the hedge will be fenced with stock and rabbit proof fencing. Selected tree species will be allowed to grow to full height, thus establishing mature trees within the hedgerow in the longer term.



Site CONDOVER

Title Restoration including plant site for BAP

Scale at A3	1:5000	Date	July 2022	Drawing No.
Drawn By	JW	Checked By	GW	

Action Plan

Item No.	Objective	Biodiversity Feature	Targets	Tasks	Assessing Indicator	Responsible Person	Timescale (Completion)
1	Creation of Eutrophic/ mesotrophic open water/ponds	Eutrophic/mesotrophic open water bodies with a variety of edge habitat including reed fringed margins and wet woodland	1 large lake (in extension) – open water for wildfowl. 4 new small shallow ponds.	1.Create wetland areas as part of progressive restoration of the site	Number and Ha restored and managed Detailed in annual report	Landscape Architect	Ongoing until 2038
2	Create grassland on existing soil stores	Neutral grassland	A mix of bare substrate, early successional communities, seasonal small Ponds.	1.Seed areas as restoration progresses. 2. Spot weed treatment as necessary.	Ha created. Detailed in annual report	Landscape Architect	Ongoing until 2038
3	Restoration and creation of hedgerows and broadleaved woodland and shrub areas.	Hedgerows encouraging birds, bats and invertebrates. Semi-natural broad-leaved woodland and scrub.	Increase in amount and diversity of hedgerow on site. Increase connectivity of habitats on site Increase in amount and diversity of woodland on site.	1. Plant and manage hedgerows in accordance with detail in Management Plan. 2. Plant and manage/create woodland areas in accordance with detail in Management Plan.	Lin. m planted and maintained Ha. planted and managed. Detailed in annual report	Landscape Architect	Ongoing until 2038
4	Create open mosaic habitat	Open mosaic habitat is frequent throughout quarries and supports early successional flora and Invertebrates on low fertility substrate.	Allow natural regeneration of species such as creeping thistle spear thistle, welled thistle, knapweed, viper's bugloss, weld, marjoram, hemp-agrimony and willow herb spp.	1.Periodic disturbance as part of quarry working. 2.Control INNS if they become dominant.	Species present. Detailed in annual report	Landscape Architect	Ongoing to 2038
5	Species conservation and management.	Mammals: Badger, Bats Birds: Sand Martin, Spotted Flycatcher, Dunnock, Song Thrush Reptiles and amphibians: Great Crested Newt.	Manage habitats for bird and mammal species. Install 3 bat boxes. Install 9 bird boxes.	1. Protect known setts/bird nesting areas making site staff aware of locations. 2. Maintain vigilance of nest sites and make site staff aware of habitat areas. Leave a suitable sand cliff for sand martins where feasible. 3. Manage habitats where the species are found to favourable condition and provide new habitat for colonisation where practical.	Number of bat and bird boxes installed. Records of species including sand martins. Records of breeding species. As per management plan/agreed with LPA.	Ecological Consultant/ Site Manager/ Landscape Architect	Bat and bird boxes installed in 2022. And ongoing until 2038.