

Old Ingleton Quarry

Site Biodiversity Action Plan



Site Information- Old Ingleton

Site Name and Location	Old Ingleton quarry located is located 2km to the north-east of Ingleton, North Yorkshire, on the western edge of the North Pennine moors Grid Ref – SD719753
Hanson Company	Hanson Aggregates - North
BAP(s) that will be targeted	UK BAP Harrogate BAP
Habitat(s) to be developed	Calcareous grassland, wetland and woodland scrub
BAP species to be encouraged	<i>Birds:</i> Peregrine <i>Amphibians:</i> Great Crested Newt (potential for breeding waders) <i>Invertebrates:</i> Brown argus
Designated Natural Area	Yorkshire Dales
Background and site description	The quarry is inactive having been last worked in the 1970s and lies adjacent to the active Ingleton Quarry. It comprises areas of poor and developing grassland, bare ground and shallow pools in the quarry and an area of calcareous grassland and mire within the older part of the quarry. Large sites of high botanical and geological interest surround the site.
National Designations (SSSI, SAC, SPAs, RAMSARs and NPs) within 500m	Ingleborough SSSI Wherside SSSI Ingleborough Complex SAC. Seato Pastures SSSI Thornton and Twistleton Glens SSSI.
Resource Requirements	Restoration budget.
Contribution to biodiversity	Calcareous grassland conservation and management is both a national and local BAP target. Upland breeding bird species are national and local BAP targets.
Partners and Local initiatives	Potential for sourcing hay from Ingleborough National Nature Reserve
Other documents supporting the site BAP	Old Ingleton Management Plan Old Ingleton Quarry Restoration Plan

Site Layout

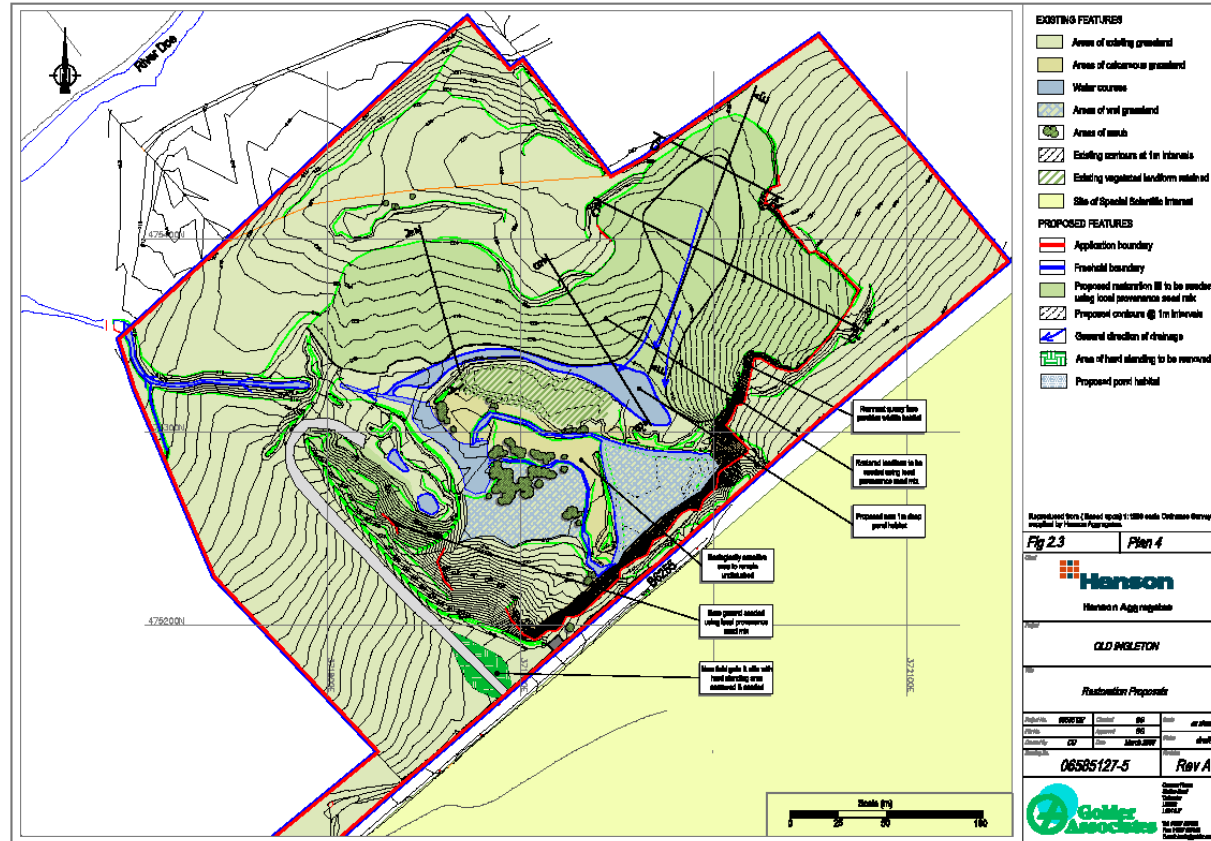

Action Plan

Item No.	Objective	Biodiversity Feature	Targets	Tasks	Assessing Indicator	Responsible Person	Timescale (Completion)
1	Habitat restoration and aftercare of restored quarry area	Calcareous grassland	Restore and manage upland calcareous grassland	1. Hay strewing 2. Permit natural revegetation 3. Grazing	Walk over survey Annual report	Landscape Architect Consultant Ecologist	Restoration and hay strewing Completed Ongoing management until 2036
2	Habitat management of naturally revegetated quarry floor	Conservation of calcareous and marshy grassland and scrub	Maintain 2ha of calcareous and marshy grassland	1. Maintain stock fencing to facilitate grazing	Walk over survey Annual report Annual winter grazing	Landscape Architect	Ongoing until 2036
3	Species conservation and management	Breeding peregrine Upland breeding birds Notable flora Brown argus	Safeguard breeding peregrine (and raven) on cliffs Manage grassland with appropriate grazing to promote breeding waders Plant common rockrose and maintain	1. Locate and protect existing known peregrine nests and limit disturbance on site by making site staff aware 2. Investigate Peregrine watching scheme. 3. Maintain winter cattle grazing 4. Plant common rock rose	Site Manager to inform site staff and contractors working close to nest sites. Annual report Site grazed annually Butterfly counts	Landscape Architect Site manager Ecologist	Ongoing until 2036
4	Habitat and species monitoring	Maintain agreed monitoring programme. Encourage local staff and public involvement where possible via local specialist groups	Ensure target habitats and species are monitored and appropriate response agreed as per management plan Bird monitoring data collected by external volunteers and ecological consultants	Annual walkover and surveys as agreed with YDNP	Monitoring reports	Landscape Architect Consultant Ecologist	Ongoing until 2036

